



Salt Wash Bay



Advantages of Fiberglass -- Safety and Efficiency

Ultra will custom design and fabricate Salt Wash Bay Platforms to meet your specifications, freestanding or wall-mounted. Higher access allows workers to spray down equipment safely. Fiberglass is the perfect alternative for applications with constant water and salt conditions, and FRP does not freeze.

Fiberglass Wash Bay components are Safety Yellow and include FRP M-shaped toe plate. Platform or Catwalk systems are shipped in assembled sections up to 20' long, designed for quick installation in existing or new buildings without the use of heavy equipment or welding.

- Corrosion Resistant - No Rust
- Non-Conductive - Both Heat & Electric
- Maintenance Free
- Long Life - Excellent ROI
- Exceeds OSHA and IBC Standards
- Light Weight
- Non-Slip Grit Grating and Stair Treads
- Safety Yellow Color
- Easy Installation, No Cranes or Welding
- High Strength

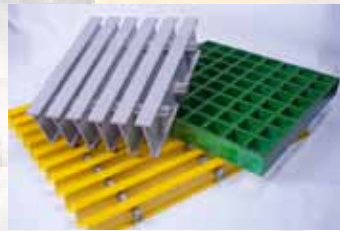

ULTRA
FIBERGLASS SYSTEMS™

Ultra Fiberglass Systems
9732 West Carmen Avenue
Milwaukee, WI 53225

phone 414.461.5051
fax 414.461.5015
www.ultrafiberglass.com



ISO 9001:2008 *Certified*



Our design team can help you find solutions to whatever application you might have. Detailed drawings are provided for approval for each custom project.

Quality craftsmanship and attention to detail go into every job. Contact us today at 414-461-5051 to quote your next project.

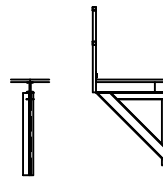
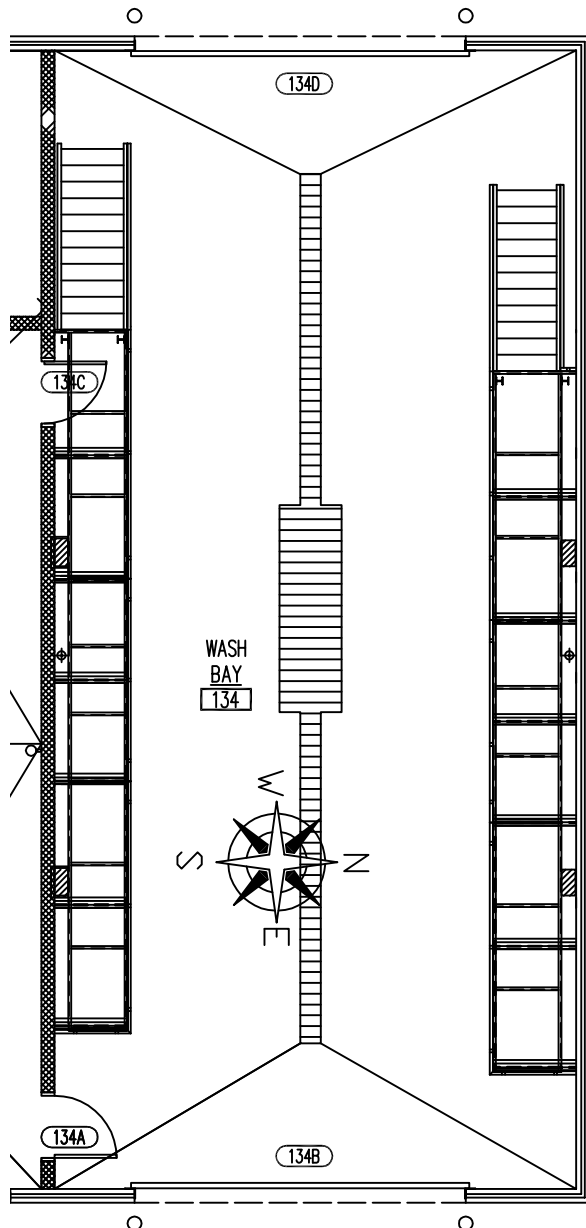

SOUTH SIDE BRACE
6 REQUIRED

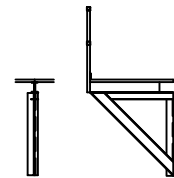

NORTH SIDE BRACE
6 REQUIRED

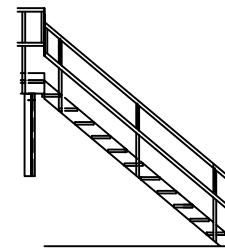

(2) STAIR RAILS REQUIRED

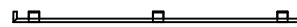

WALL MOUNTED STAIR RAIL
(1) REQUIRED

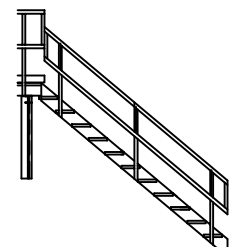
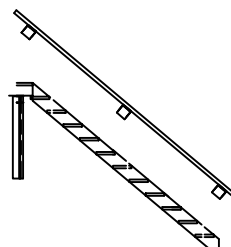

TYP STAIR ELEVATION
(1) REQUIRED